

## SP-438DS

电子钉扣机 (新款)

Electronic Button Attaching Machine

SP-438DS (平扣 / Flat button)

SP-439DS (立扣 / Shank button)



### 性能优势

一体式设计: 机械部份与电控一体式设计;

新型抬压脚机构: 压脚行程两段式控制, 数据化调节压脚高度, 精准落针起缝点;

触摸屏操作面板: 完全可视化的人机界面, 只需手指轻触即可完成人机对话, 根据图标可快速简便的编辑缝纫花样;

无油式针杆: 可杜绝缝料的污染;

高转速: 最高转速2700 rpm, 完全按照缝制数据进行高质量缝纫;

耗电少: 采用无传动损失的电脑直接驱动方式, 并装备了小型节电马达, 耗能量与传统机型比削弱了35%。

### Advantages

Integrated design: mechanical part and electric control all in one design;

New presser foot lifting design: two-stage control of presser foot stroke, digital adjustment of the height, precise needle drop starting point;

Touch panel: friendly using interface, could edit sewing patterns quickly by touch screen;

Oil-free needle bar: avoid the pollution on fabric;

High speed: Max speed is 2700 rpm, which can carry out high-quality stitches according to the setting;

Low power consumption: direct drive mode, compared with traditional models decrease 35%.

### 适用范围

SP-438DS适用于各种衣物平扣缝制

缝制纽扣外径尺寸为8-30mm, 纽扣的缝制区域为6.4-6.4mm

SP-439DS用于装订各种立扣, 立扣的缝制区域为3.4mm×0mm

### Application

SP-438DS is suitable for sewing flat buttons of all kinds of clothes

The outer diameter of the sewing button is 8-30mm and the sewing area of the button is 6.4-6.4mm

SP-439DS is used to stitch various standing buttons, the sewing area of standing buttons is 3.4mm×0mm

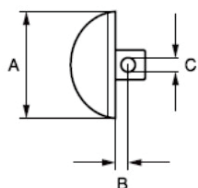

A: <math>< \varnothing 18\text{mm}</math>  
B: > 1.5mm  
C: > <math>\varnothing 1.5\text{mm}</math>

SP-439DS



触摸屏操作面板  
Touch screen



视频及资料下载  
Video and data download

型号 Model	SP-438DS	SP-439DS	针距 Stitch length	0.1-12.7mm
最高缝纫速度 Highest sewing speed	2,700 rpm	2,700 rpm	重量 Weight	60Kg
缝制范围 Sewing range	6.4×6.4mm	3.4×0mm	机器尺寸 Machine size	610×250×430mm(L×W×H)
可缝制纽扣尺寸 Dimensions of button	8-30mm	直径 <math>< 18\text{mm}</math>	电压 Voltage	单相 Single phase 220V

以上基础参数表为标准款机型